



For Sale

± 6.3 Acres

HOME DEPOT OUTPARCEL

Lakeside Parkway @ International Parkway
Town of Flower Mound, Texas

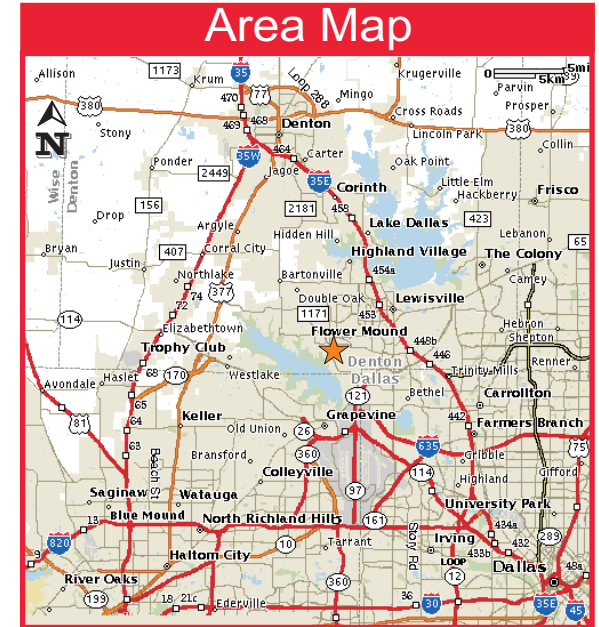

Contact Information

Mike Stevens

mstevens@stevecogroup.com

Steveco Commercial
Real Estate Group
15301 Spectrum Drive
Suite 400
Addison, TX 75001

T 972.233.7979

F 972.789.2977

www.stevecogroup.com



Location: FM 2499 (International Pkwy) @ Lakeside Pkwy
Town of Flower Mound (Denton County) Texas

Size: 6.3 Acres
(± 374' x ± 700')

Zoning: PD31-Campus Commercial

Access: International Pkwy (FM 2499)
Lakeside Pkwy.
Lake Forest Blvd.

Traffic : FM 2499 - 37,000 V.P.D. (01')
Counts Lakeside Pkwy - N/A (open 10/02)

HOME DEPOT OUTPARCEL

Lakeside Parkway @ International Parkway
Town of Flower Mound, Texas

Demographics

	3 Mile	5 Mile	10 Mile
2001 Population Est.	28,924	105,454	510,449
2001 Median HH Income	\$70,355	\$78,471	\$70,751
2001 Employment	18,581	86,270	337,957
Town of Flower Mound 2002 Population Est.	55,700		

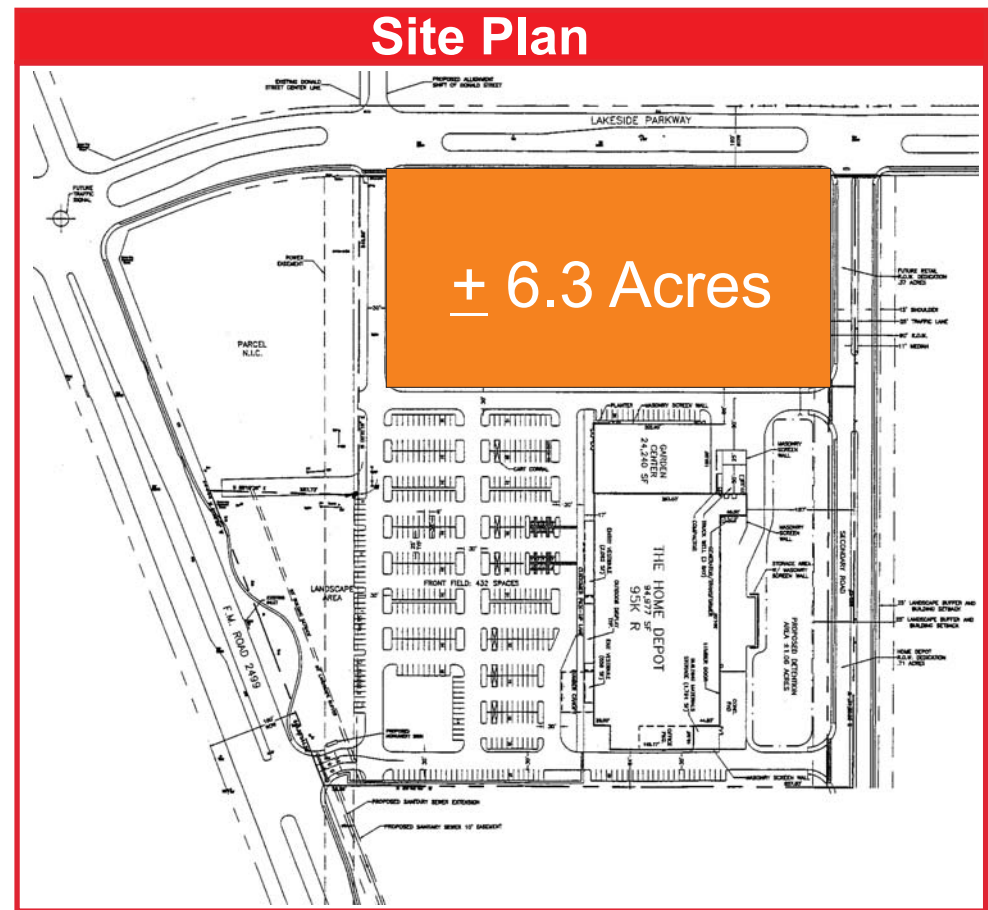

Contact Information

Mike Stevens

mstevens@stevecogroup.com

Steveco Commercial
Real Estate Group
15301 Spectrum Drive
Suite 400
Addison, TX 75001

T 972.233.7979
F 972.789.2977

www.stevecogroup.com



The information above has been obtained from sources believed reliable. While we do not doubt its accuracy, we have not verified it and make no guarantee, warranty or representation about it. It is your responsibility to independently confirm its accuracy and completeness. You and Your advisors should conduct a careful, independent investigation of the property to determine to your satisfaction the suitability of the property for your needs.

© 2002 Steveco Commercial Real Estate Group.